

PRODUCT DESCRIPTION

Dossier direct

DOCUMENT VERSION: 2.0

Figure 1. Example of a map in the dossier.

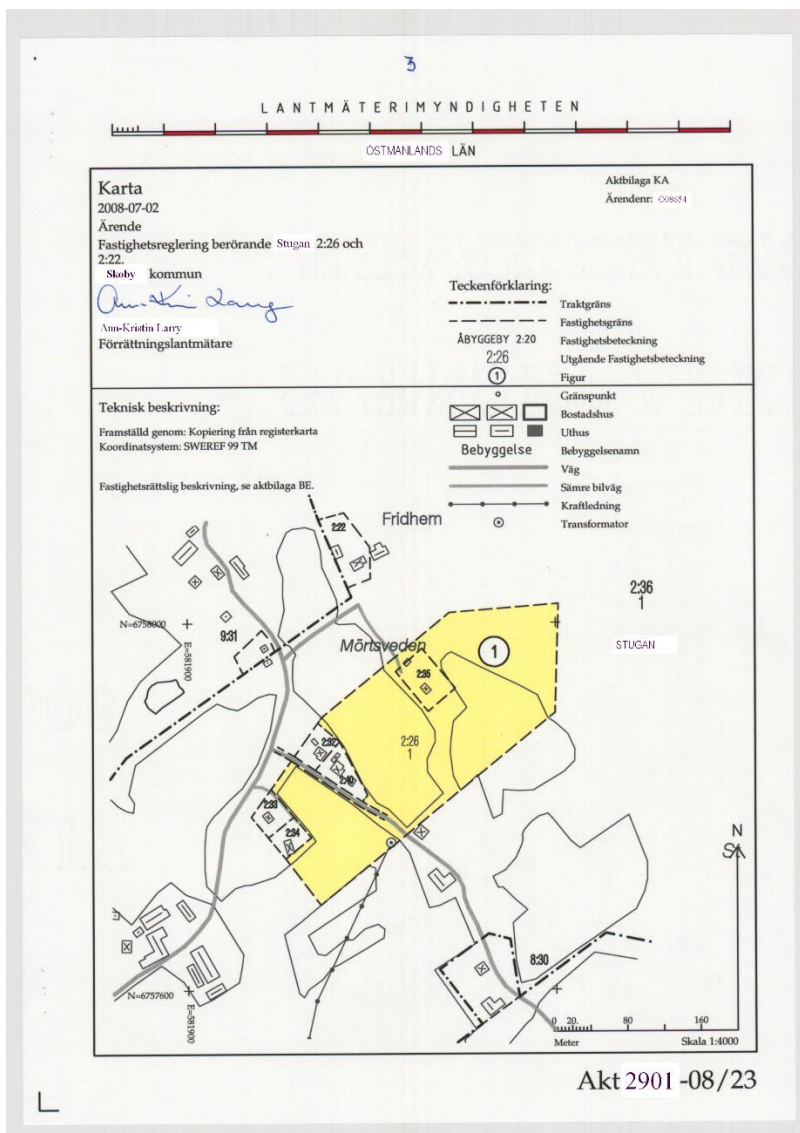

Table of contents

1	GENERAL DESCRIPTION	3
1.1	GEOGRAPHICAL COVERAGE	3
1.2	COORDINATE SYSTEM	3
2	QUALITY DESCRIPTION	4
2.1	PURPOSE AND USES	4
2.2	DATA CAPTURE	4
2.2.1	<i>Lineage</i>	4
2.3	MAINTENANCE	4
2.3.1	<i>Maintenance frequency</i>	5
2.4	QUALITY OF DATA	5
2.4.1	<i>Location accuracy</i>	5
2.5	METADATA	5
3	FEATURES	6
3.1	RETRIEVE DOSSIER	6
4	LIST OF CHANGES	7

I General description

Dossier direct is a service for integrating access to dossier that are in a part of Lantmäteriet, the Swedish mapping, cadastral and land registration authority's archive to own systems. The service provides dossier from state and municipal cadastral archives that are available at the National Land Survey. The dossier are provided in the image format DjVu and an image viewer is needed to be able to see the images. The service has an http-based machine-to-machine interface. Detailed information can be found in the technical description for Dossier direct.

All changes to a property take place through a surveying service and the results are archived for all time in a dossier. These dossier's usually contains a map with associated documents and describes how the property was formed or if it has changed from the origin. The document describes how the cadastral procedure has been carried out and what decisions have been made, as well as information about communities, community facilities, easements and rights.

The archives also include detailed plans and other land regulations.

The information in the Real Property Register has been taken from the dossier's, which means that the complete documentation about a property is in the dossier. There are more dossier than those that are linked to the Real Property Register because not all dossier are registered in the register. To find these dossier, you can use ArkivSök (FileSearch).

1.1 Geographical coverage

The maps and dossier provided from Lantmäteriet's archives via Dossier direct come from cadastral procedures conducted throughout almost all of Sweden.

1.2 Coordinate system

In the oldest dossier there is no coordinate system. For the maps in newer dossier, the coordinate system used is shown on the map or in the document.

2 Quality description

In the oldest dossier there is no coordinate system. For the maps in newer dossier, the coordinate system used on the map or in the document is shown

2.1 Purpose and uses

Dossier direct provides access to some of the dossier in Lantmäteriet's archives. To use the service, you must have an application and DjVu software that can handle the service.

The user must be able to use the dossier in their own system / software.

Examples of possible uses are;

- cadastral procedure
- archive investigations
- community planning
- planning of infrastructure
- forestry
- property management
- estate agent

2.2 Data capture

2.2.1 LINEAGE

The material has been added by cadastral surveyors who have created dossier, maps and / or documents, over a geographical area or several properties. These documents have then been scanned or archived digitally and are available via Dossier direct. The map material is not georeferenced.

For the scanned material, most of the maps are scanned in color and have a resolution of 254 dpi. The documents have been scanned in black and white with a resolution of 200 dpi. From March 2018, maps and documents will be scanned in color with a resolution of 300 dpi.

All material that is archived digitally from Lantmäteriet's processing system has a resolution of 300 dpi. This is material at the earliest from 2008 onwards, depending on when the surveying office started digital archiving.

All TIFF files are converted to DjVu format.

2.3 Maintenance

The archives are updated from Lantmäteriet's processing system for property formation. Supplementary scans from existing analogue cadastral archives may occur. Work is underway to scan analog dossier from the municipalities' building committee archives so that they can be searched in Lantmäteriet's archives.

2.3.1 MAINTENANCE FREQUENCY

The information in the service is updated daily with administrative documents from the state and municipal Cadastral Authorities in connection with property development.

2.4 Quality of data

2.4.1 LOCATION ACCURACY

The position accuracy of the maps depends on when they were created. The maps have been produced over a long period of time and with widely differing measurement methods. For e.g. the boundary points, the position accuracy can vary from a few centimeters to a number of meters.

On the older maps, the internal position accuracy (how the objects are in relation to each other on the ground) is very good, but there is no information about the external position accuracy (how the objects are located in Sweden).

Since the 1990s, the measurement has taken place with satellite positioning with the recommended position accuracy according to the Handbok i mät- och kartfrågor (Handbook of measurement and map issues), HMK. With satellite positioning, both internal and external position accuracy is very good.

The position accuracy is stored in the form of mean errors given in millimeters.

2.5 Metadata

The service only provides dossier, without related metadata. To be able to use the service, it is required that you have access to a dossier designation, for example from Lantmäteriet's Real Property Register.

3 Features

3.1 Retrieve dossier

A dossier is retrieved by entering the county and the dossier designation. A dossier can contain one or more images.

This service sends a request to retrieve a dossier from Lantmäteriet's archive and the answer that is returned is all the pictures in the dossier. It is when all the images in the dossier are retrieved that the selected DjVu viewer opens the dossier. This means that dossier with many images may take longer to open than dossier with few images.

Figure 2. Flow chart of how dossiers are retrieved

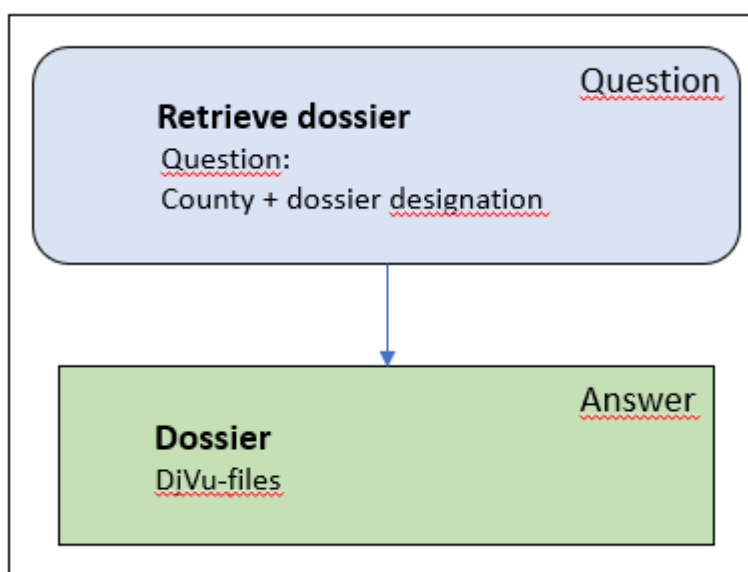

To be able to watch a DjVu, a DjVu viewer is required. There are several options today, for example;

- Download dossier and view dossier in a separate program, DjVu Viewer (new solution)
- Retrieve dossier with DjVu plugin
- Retrieve dossier with simplified DjVu viewer, html5

For more information, see the technical description for Dossier direct

4 List of changes

Table 1. Table of change list.

Version	Datum	Orsak samt ändring mot tidigare version
1.0	2018-12-04	New document
2.0	2020-06-01	The document has changed under Chapter 3 Functions. Changed way to download dossier.